



*ACO Marine Product catalogue*  
**Gullies**

## ACO Marine EG150 Range



ACO Marine has designed a new and wide range of multi-application, high performance stainless steel floor gullies.

The ACO Marine EG150 range of gullies is designed to provide hygienic, quick, simple and economic trapped drainage solutions for washrooms, toilets, 'wet' bathrooms, changing rooms, galleys, swimming pools, etc.

All floor finishes, including all cement and resin screeds, ceramic tiles, flexible vinyl sheet in solid and suspended flooring applications are catered for.

Manufactured from austenitic 304 grade stainless steel as standard; excellent corrosion resistance is guaranteed. Optional 316Ti grade stainless steel for aggressive applications is available in all gullies.

Additional features include compact design, removable in-line foul air trap is fitted as standard, with a choice of vertical or horizontal spigot outlets, telescopic height adjustment and full rotational adjustment for tiles, wall or equipment alignment.

Optional side inlet facilities are provided to fit the hand basin and the condensation waste pipes.

### Product Benefits

- Corrosion resistant 304 austenitic stainless steel construction
- 316Ti austenitic stainless steel option for aggressive environments
- Ultra-compact design ideal for suspended floor applications
- Quick, easy installation in screed, tiled or flexible vinyl flooring finishes
- Foul air trap fitted as standard, flow rate 1.2 l/sec
- Choice of 0 110, 75 and 50 mm vertical or 0 75 and 50 mm horizontal spigot outlets
- Foot safe, fitted as standard for pedestrian applications
- Smooth contour design minimises bacteria traps
- Attractive, neat appearance
- Telescopic height variant providing full 360° rotation and +/- 7.5° pitch & roll adjustment
- End stops provided preventing accidental dismantling on telescopic variants
- Three side inlets variants optionally available, supplied with fully interchangeable adaptors to suit 32 mm and 40 mm waste pipes
- Supplied boxed complete with fitting instructions - no loose parts

### Typical Applications

- Washrooms
- Wet bathrooms
- Toilets
- Galleys
- Leisure centres
- Swimming pools



## One part gullies

### One part gully for steel decks with vertical outlet

	<i>D1</i> (mm)	<i>D2</i> (mm)	<i>H1</i> (mm)	<i>H2</i> (mm)	<i>T</i>	<i>Weight</i> (kg)	<i>Part No.</i> <i>AISI 304</i>	<i>Part No.</i> <i>AISI 316Ti</i>
with foul air trap	50	140	175	22	2	1,50	410116	410117
	75	140	175	22	2	1,65	410118	410119
	110	140	175	22	2	1,50	410120	410121
without foul air trap	50	140	175	22	2	1,20	410122	410123
	75	140	175	22	2	1,35	410124	410125
	110	140	175	22	2	1,20	410126	410127

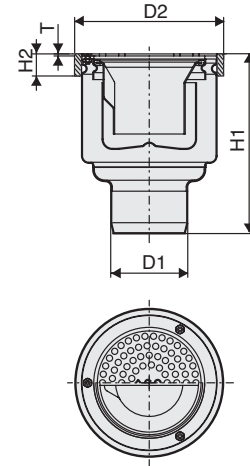

### One part gully for steel decks with horizontal outlet

	<i>D1</i> (mm)	<i>D2</i> (mm)	<i>H1</i> (mm)	<i>H2</i> (mm)	<i>H3</i> (mm)	<i>B</i> (mm)	<i>T</i> (mm)	<i>Weight</i> (kg)	<i>Part No.</i> <i>AISI 304</i>	<i>Part No.</i> <i>AISI 316Ti</i>
with foul air trap	50	140	107	70	16	205	2	1,50	410128	410129
	75	140	107	62	16	200	2	1,50	410130	410131
without foul air trap	50	140	107	70	16	205	2	1,20	410132	410133
	75	140	107	62	16	200	2	1,20	410134	410135

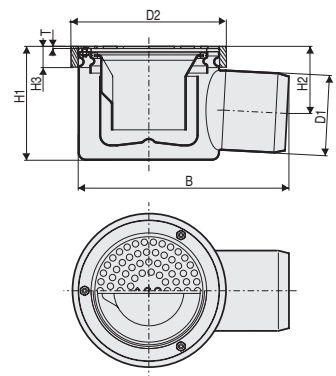

## Two part gullies

### Lower parts

#### Lower part with vertical outlet and welding ring

D1 (mm)	D2 (mm)	H1 (mm)	H2 (mm)	Weight (kg)	Part No. AISI 304	Part No. AISI 316Ti
50	159	175	30	1,50	410070	410071
75	159	175	30	1,60	410072	410073
110	159	175	30	1,70	410074	410075

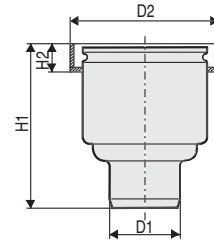

#### Lower part with vertical outlet and welding flange

D1 (mm)	D2 (mm)	D3 (mm)	H (mm)	Weight (kg)	Part No. AISI 304	Part No. AISI 316Ti
50	159	210	175	2,10	410076	410077
75	159	210	175	2,20	410078	410079
110	159	210	175	2,30	410080	410081

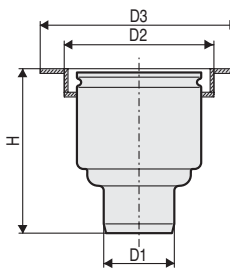

#### Lower part with horizontal outlet and welding ring

D1 (mm)	D2 (mm)	H1 (mm)	H2 (mm)	H3 (mm)	B (mm)	Weight (kg)	Part No. AISI 304	Part No. AISI 316Ti
50	159	107	70	22	205	1,50	410082	410083
75	159	107	62	22	200	1,60	410084	410085

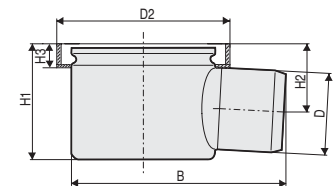

#### Lower part with horizontal outlet and welding flange

D1 (mm)	D2 (mm)	D3 (mm)	H1 (mm)	H2 (mm)	B (mm)	Weight (kg)	Part No. AISI 304	Part No. AISI 316Ti
50	159	210	107	70	205	2,20	410086	410087
75	159	210	107	62	200	2,10	410088	410089

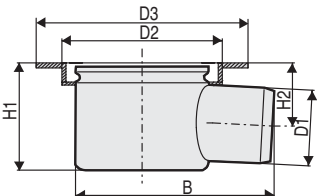

#### Note:

In order to avoid any damage to the seal ring between the lower and the upper parts of the gully through welding, the lower part is delivered without the seal ring. The seal ring is attached to the upper part of the gully. Before the assembly of the lower and upper parts, it is necessary to correctly insert the seal ring into the lower part of the gully; according to the following montage instructions:

1. Remove the seal ring from the spigot end of the upper part of the gully.
2. Ensure that the seal ring itself and the zone around the lower part of the gully receiving the seal is clean, dry and free from dust, grit and any metallic particles.

3. Insert the dry seal ring into the lower part of the gully as shown in the diagram below:

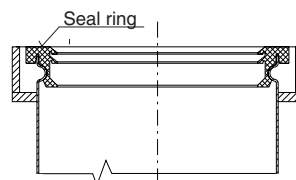

4. When assembling the lower and upper parts of the gully apply the lubricant (Order No 400520) sparingly to the lips to aid insertion.
5. Do not use any tools to aid the assembly process, otherwise damage to the gully seal ring may occur.



## Two part gullies

### Upper parts

#### Upper part for tiled or screeded floors

	<i>D</i> (mm)	<i>BxB</i> (mm)	<i>H1</i> (mm)	<i>H2</i> (mm)	<i>Weight</i> (kg)	<i>Part No.</i> <i>AISI 304</i>	<i>Part No.</i> <i>AISI 316Ti</i>
with foul air trap	110	150x150	92	10	1,05	410090	410091
without foul air trap	110	150x150	92	10	0,75	410092	410093

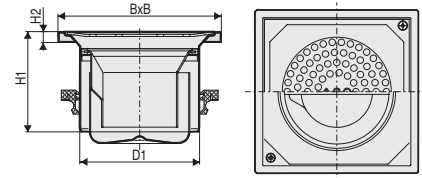

#### Upper part for vinyl floors

	<i>D1</i> (mm)	<i>D2</i> (mm)	<i>H1</i> (mm)	<i>H2</i> (mm)	<i>Weight</i> (kg)	<i>Part No.</i> <i>AISI 304</i>	<i>Part No.</i> <i>AISI 316Ti</i>
with foul air trap	110	225	98	19	1,25	410094	410095
without foul air trap	110	225	98	19	0,95	410096	410097

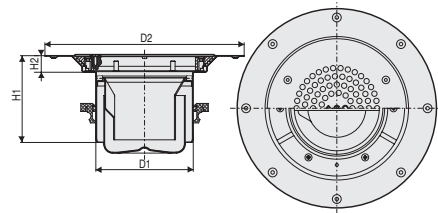

#### Upper part with gully top for mesh grate

	<i>D</i> (mm)	<i>BxB</i> (mm)	<i>H1</i> (mm)	<i>H2</i> (mm)	<i>Weight</i> (kg)	<i>Part No.</i> <i>AISI 304</i>	<i>Part No.</i> <i>AISI 316Ti</i>
with foul air trap	110	150x150	106	21,5	1,05	410098	410099
without foul air trap	110	150x150	106	21,5	0,75	410100	410101

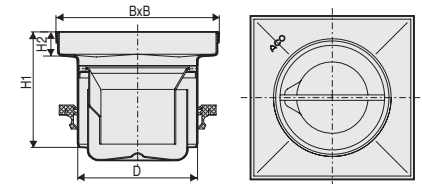

#### Upper part with three side inlets for tiled or screeded floors

	<i>D</i> (mm)	<i>BxB</i> (mm)	<i>H1</i> (mm)	<i>H2</i> (mm)	<i>H3</i> (mm)	<i>C</i> (mm)	<i>Weight</i> (kg)	<i>Part No.</i> <i>AISI 304</i>	<i>Part No.</i> <i>AISI 316Ti</i>
with foul air trap	110	150x150	184-199	62-77	30	186	2,05	410102	410103
without foul air trap	110	150x150	184-199	62-77	30	186	1,75	410104	410105

Note: Diameter of side inlets are 32 and 40 mm available.

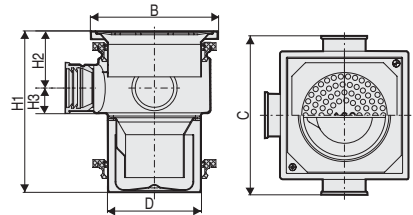

#### Upper part with three side inlets for vinyl floors

	<i>D1</i> (mm)	<i>D2</i> (mm)	<i>H1</i> (mm)	<i>H2</i> (mm)	<i>H3</i> (mm)	<i>C</i> (mm)	<i>Weight</i> (kg)	<i>Part No.</i> <i>AISI 304</i>	<i>Part No.</i> <i>AISI 316Ti</i>
with foul air trap	110	225	194-209	72-87	30	186	2,15	410106	410107
without foul air trap	110	225	194-209	72-87	30	186	1,85	410108	410109

Note: Diameter of side inlets are 32 and 40 mm available.

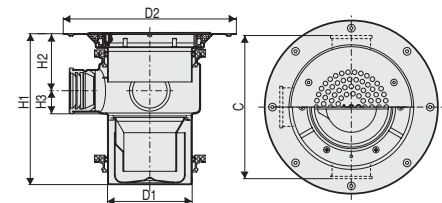

#### Upper part with three side inlets and with gully top for mesh grate

	<i>D</i> (mm)	<i>BxB</i> (mm)	<i>H1</i> (mm)	<i>H2</i> (mm)	<i>H3</i> (mm)	<i>C</i> (mm)	<i>Weight</i> (kg)	<i>Part No.</i> <i>AISI 304</i>	<i>Part No.</i> <i>AISI 316Ti</i>
with foul air trap	110	150x150	198-213	76-91	30	186	1,85	410110	410111
without foul air trap	110	150x150	198-213	76-91	30	186	1,85	410112	410113

Note: Diameter of side inlets are 32 and 40 mm available.

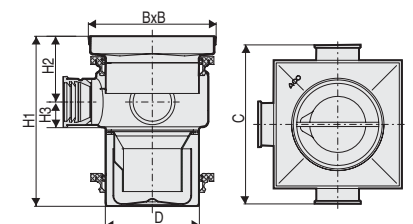

## Shower gullies

### Shower gully

D (mm)	BxB (mm)	H (mm)	Weight (kg)	Part No. AISI 304	Part No. AISI 316Ti
32	150x150	52	0,70	400791	400792

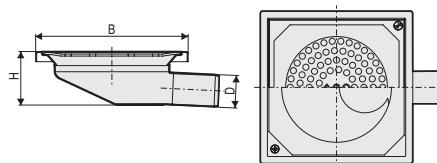

### Shower gully with welding ring

D1 (mm)	D2 (mm)	BxB (mm)	H1 (mm)	H2 (mm)	H3 (mm)	Weight (kg)	Part No. AISI 304	Part No. AISI 316Ti
32	120	150x150	62-72	45	5	1,25	410114	410115

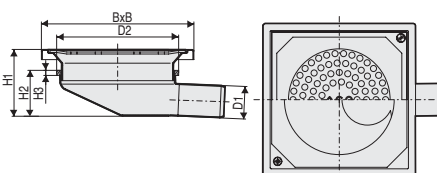

## Accessories

### Extension pipe

D (mm)	H (mm)	Weight (kg)	Part No. AISI 304	Part No. AISI 316Ti
110	60	0,35	410136	410137

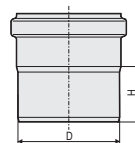

### Foul air trap

D (mm)	H1 (mm)	H2 (mm)	Weight (kg)	Part No. AISI 304	Part No. AISI 316Ti
108	85	50	0,30	97217	97267

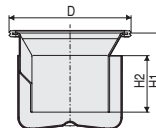

### P-Trap

D (mm)	H1 (mm)	H2 (mm)	H3 (mm)	B (mm)	Weight (kg)	Part No. AISI 304	Part No. AISI 316Ti
50	68	78	149	187	0,50	98822	98872
75	94	86	193	232	0,70	98824	98874
110	132	95	254	300	1,30	98826	98876

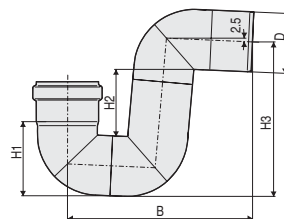

### Sieve (optional)

Weight (kg)	Part No. AISI 304	Part No. AISI 316Ti
0,10	97235	97285



### Mesh grate antislip

Weight (kg)	Part No. AISI 304	Part No. AISI 316Ti
0,60	05964	15964

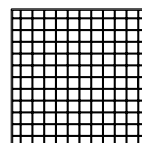

### Mesh grate plain

Weight (kg)	Part No. AISI 304	Part No. AISI 316Ti
0,60	05965	15965



### Lubricant 500 ml

Weight (kg)	Part No.
0,60	400520



## Custom made Solutions

ACO Marine is ready and willing to design, produce and deliver tailor made drainage solutions for a wide range of specific needs in addition to the modular products listed above in this catalogue.

On top of drainage solutions ACO Marine is able to deliver a wide range of aesthetically pleasant stainless steel gratings and covers.

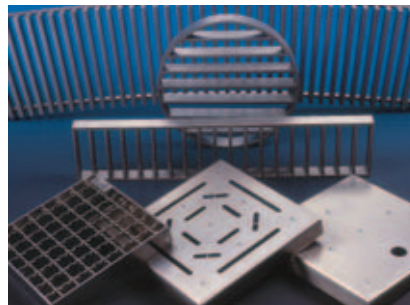
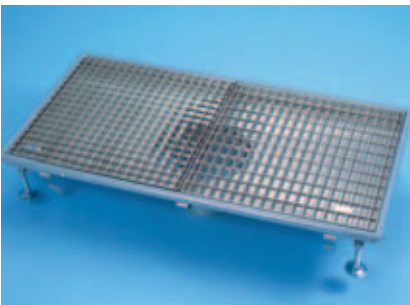

**ACO Industries k.s.**

582 22 Příbyslav  
Havlíčkova 260  
Czech republic  
Tel.: +420 569 491 111  
Fax: +420 569 482 529  
www.aco.cz  
**e-mail: [aco@aco.cz](mailto:aco@aco.cz)**

**ACO Marine Deutschland**

Rosenweg 10  
D-27793 Wildeshausen  
Germany  
Tel: +49 4431 738 874  
Fax: +49 4431 738 875  
**E-mail: [kdziuk@acomarine.com](mailto:kdziuk@acomarine.com)**

© June 2006 ACO Marine. All reasonable care has been taken in compiling the information in this document. All recommendations and suggestions on the use of ACO products are made without guarantee since the conditions of use are beyond the control of the Company. It is the customer's responsibility to ensure that each product is fit for its intended purpose and that the actual conditions of use are suitable. This brochure and any advice is provided ACO Marine free of charge and accordingly on terms that no liability (including liability for negligence) will attach to the Company or its servants or agents arising out of or in connection with or in relation to this brochure or any such advice. Any goods supplied by the Company will be supplied solely upon its standard conditions of sale, copies of which are available on request. The Company's policy of continuous product development and improvement renders specifications liable to modification. Information provided in this brochure is therefore subject to change without prior notification.